

## Rosie Shelf Sitter

Approximately 16 inches tall

### You Will Be A Needin':

Material: Muslin, pink satin for dress  
Hair: Country red 4-ply sport weight yarn  
Embroidery thread: Brown #300, red #3777, thread that matches dress, natural, dark green, pink  
Colored pencils: Dark green and pink  
Light Box or sunny window  
Mechanical pencil  
Stuffing  
Terra cotta saucer (4 inches across top)  
Dinner plate 7 or 8 inches across (to use as pattern)  
Disappearing fabric marking pen  
Paint: Barnyard red, black, antique white  
Sponge brush and large stencil brush  
Paper towels and paper plates  
5-inch doll needle  
Small embroidery needle  
Staining: Instant coffee, vanilla extract, fragrance oil, wire hanger, old cookie sheet, glass jar with lid, wax paper, pliers  
Vintage or antique lace both 2 inches wide and 1/2 inch wide

## Lillie Mae's Crafts

Muncie, IN USA

<http://www.lilliemaeecrafts.com>

[lilliemaeecrafts@yahoo.com](mailto:lilliemaeecrafts@yahoo.com)

## Rosie Shelf Sitter



By Brenda Greenwalt  
of Lillie Mae's Crafts

# Lillie Mae's Crafts

A Lillie Mae's Crafts original design by Brenda Greenwalt

**Rosie**

Read through all directions before beginning.

Approximately 16 inches tall when completed

For illustrations of the different steps and techniques as well as the stitches visit my "Stitch 'n' Stuff" page on my website at <http://www.lilliemaescrafts.com>

**Note:** Even though there are instructions telling you when to stain material, laces, cheesecloth, etc., you may want to stain it all before beginning to save time.

## Instructions:

1. Print out head, arm and leg patterns.
2. Pin head, arm and leg patterns to doubled muslin and trace using pencil, disappearing or Mark B Gone fabric marking pens being sure to trace 2 arms and 2 legs.
3. Sew on traced lines leaving open where indicated on patterns. I stuff my dolls fairly firmly; to prevent seams from popping due to stress placed on them, set your sewing machine for small stitches. Clip curves and turn.

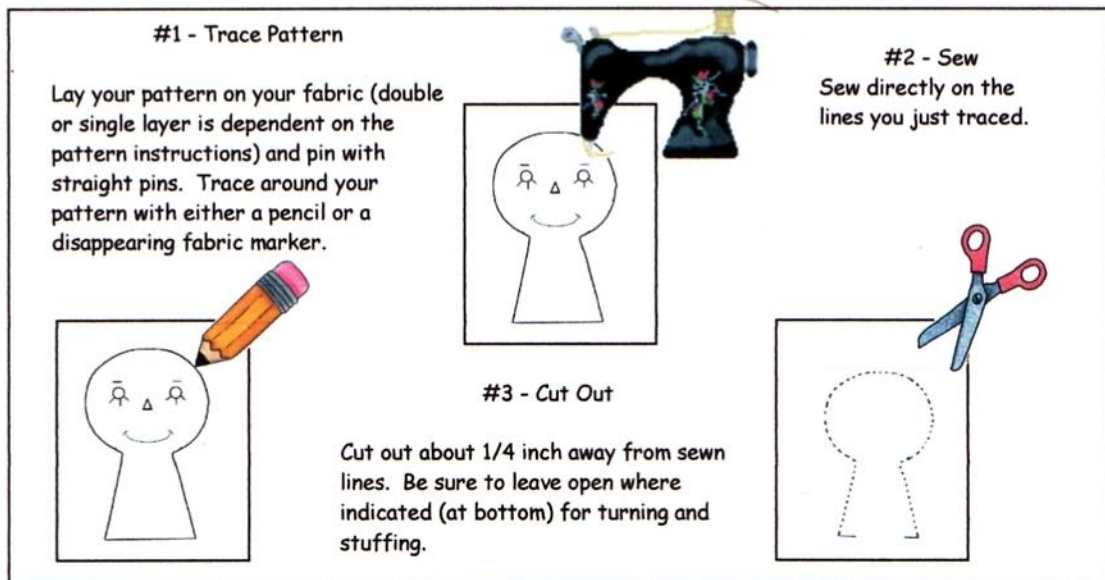

4. Stuff to stuffing lines and sew openings closed.
5. Sew arms on where indicated on pattern. (Do NOT attach the legs yet.)

## Stain:

Stain the head, arms and legs.

1. Mix stain solution; in a glass jar with lid combine 1/4 cup instant coffee with 1 cup hot water. Add 2 teaspoons vanilla extract and 1/4 teaspoon fragrance oil. Shake to mix. If you want your stain mixture more fragrant, simply add more fragrance oil. Pour into a spray bottle or use sponge brush.
2. Line an old cookie sheet with either wax paper or old rags.
3. Spray body being sure she is completely covered; front and back.
4. Set oven to 200 and bake for 10 minutes. NEVER LEAVE THIS UNATTENDED. If you need to bake longer, bake at 5 minute increments.

#### **Face:**

1. Print off eyes and nose patterns. Position on face where desired and attach with straight pins.
2. With pencil, lightly trace around patterns.
3. Eyes: Paint eyes in with black paint. Be careful, use a very small brush, and go slowly. When dry, with white fine point paint pen, place dot in eye (see picture).
4. Mouth, eyebrows & eyelashes: With one strand brown embroidery and using your 3 to 5 inch doll needle, go in from top of head (this will be hid with her hair) and backstitch mouth first, then eyelashes and finally the eyebrows.
5. Nose: With 2 strands red embroidery thread and using the same technique as above in step #4, backstitch her nose.
6. Cheeks: Dip a small amount of your Country Red paint onto a paper plate. Dip your small stencil brush lightly in the paint and dab almost all of the paint back off on the paper towels. When you have only a small amount left on your brush, using circling motions, paint on her cheeks as in the picture. If you want more color, repeat.

#### **Hair:**

1. Cut 3 pieces of yarn each about 4 inches long. Insert these in the 3 places marked on head.
2. Print and cut out hair card. Wrap yarn around hair card 50 times; slide yarn off card and center this over top of head.
3. Wrap yarn around your 4 fingers held tightly together about 10 times; slide off. Center this and lay on top of hair (above). Tie this all tightly to the head with the piece of 4 inch yarn that was inserted there. Tie the sides also.
4. The yarn is 4-ply sport weigh yarn. So I want you to unthread the yarn in half so that each 4-ply strand is now 2 and 2-ply.
5. Print and cut out the hair bow patterns. Place this on top of doubled cheesecloth and cut out. Stain with recipe and directions given below. Tie pigtails up and tie bows in place.

#### **Paint Feet:**

1. Tie small piece of thread to the top of the legs. This is to hang them to dry after painting.
2. Paint feet (shoes) back as indicated on pattern.
3. Hang to dry. I usually use a wire hanger. Bend both sides up, and hang one leg on each side. Be sure not to hang where possible drippings from the paint may cause damage. I hang mine in my garage.
4. Once dry, lightly sand the shoes to give them appearance of vintage and worn shoes.

5. With antique white embroidery floss, thread through shoes to resemble shoe strings.

### **Body:**

1. For the body pattern, simply use a 7 or 8-inch dinner plate. Trace around this with disappearing fabric marking pen onto doubled muslin.
2. With 2 strands of natural embroidery floss hand sew a running stitch completely around this about 1/2 inch from the edge leave enough thread for gathering.
3. Place your terra cotta saucer in the center of this and pull gathering thread until material has cupped up a bit around the saucer.
4. Grab a handful of polyfil and place in center of saucer (do not overstuff); place doll in center.
5. Pull the gather stitch tight and hand stitch to the doll all around. You may need to do this several times to make sure it is snug and tight.

### **Legs & Bloomers:**

1. Next we make the bloomers as they need to go on the doll's legs before the legs are attached the doll.
2. Print off bloomer pattern. On doubled muslin trace pattern with disappearing fabric marking pen. As above, sew on traced lines being sure to leave top and bottom open as indicated on pattern. Cut out about 1/4 inch from sewn lines.
3. Pin lace in place and sew.
4. Put on dolls legs. With natural embroidery floss, hand sew a running stitch around bottom of bloomers about 1/2 inch from bottom. Pull to gather and stitch down in back.
5. Glue to bottom of saucer as indicated in picture being sure that the toes are pointed towards each other.

### **Dress:**

1. Bodice - On double layer material, right sides together, pin bodice pattern and cut out, being sure to place the bodice on the fold as indicated.
2. Skirt - On doubled layer material, right sides together, pin skirt pattern placed on fold where indicated and cut out 2.

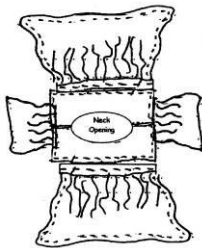

3. Doing front and back separately, take one piece of the cut out skirts and sew a gathering or a running stitch about 1/4" away from one long edge.
4. Gather that part of the skirt and with right sides together match it to the bottom of the bodice. Pin & sew right above the gathering stitch.
5. Do the same for the other side of the bodice.
6. With right sides together, match up the front and back dress pieces and, using 1/4 inch seam allowance, sew together.
7. Turn hem under 1/4 inch and pin lace in place; hem.
8. Turn bottom of sleeves up about 1/4 inch, pin lace in place and and sew.
9. Slip dress on over doll's head. Hand stitch a running stitch completely around neck and sleeves and pull to gather, knot.

### **Rose Pillow:**

1. Print and cut out pillow pattern. Trace on double muslin and cut out; trace once more on single layer muslin and cut out. You should have 3 layers.
2. Tape the printed off rose design over your light box. Tape or pin one layer of muslin on top of this. With a mechanical pencil, trace the pattern.
3. Layer a blank piece of muslin underneath the rose you just traced and with pink embroidery floss, backstitch the rose. With green embroidery floss, backstitch the leaves.
4. With pink and green colored pencils, color in the rose and leaves.
5. If you haven't stained the pillow material, stain all of it now including the embroidered rose.
6. Place right sides together and sandwich the lace on all four seams. With right sides together, sew all four side seams for the pillow; do NOT leave an opening. Cut out about 1/4 inch away from sewn lines.
7. In center back, cut a small opening for turning. Turn. Press.
8. Stuff firmly.

### **Staining Recipe and Instructions:**

#### Supplies Needed:

- Instant coffee
  - Vanilla extract
  - Fragrance oil (optional, Cinnabun is one of my favorites)
  - Old cookie sheet
  - Small spray bottle or sponge brush
  - Funnel (if using a spray bottle)
1. Mix together in glass jar with lid -  $\frac{1}{4}$  cup instant coffee, 2 cups hot water and  $\frac{1}{4}$  cup vanilla extract.
  2. Add fragrance oil to your taste. (HINT: You may want to add just a little at first and add more if you desire. If you add too much to begin with it may be stronger than you prefer.)
  3. Pour stain into spray bottle or apply with sponge brush.
  4. Lay the item you are staining on cookie sheet. Spray front and back thoroughly or apply stain with sponge brush. Be sure to cover item completely with stain.
  5. Bake in oven at 200 degrees for 10 minutes. If you need to bake longer, only bake at 5 minute increments.

NEVER LEAVE THIS UNATTENDED. THIS CAN CATCH ON FIRE. KEEP CHILDREN AND PETS AWAY. WATCH CLOSELY.

### **Terms of Use:**

All of my craft patterns are copyrighted. You may create a reasonable amount of items from my patterns for craft fairs, bazaars, craft malls, and auctions as long as you give Lillie Mae's Crafts credit for the design. You MAY NOT mass produce items from my patterns. Copying for any reason at all is strictly prohibited. You DO NOT have permission to alter them in any way. No wholesaling of items made from my patterns. My patterns are not to be shared or redistributed in any form without my express permission. If you have any questions, please feel free to e-mail me at [lilliemascrafts@yahoo.com](mailto:lilliemascrafts@yahoo.com)

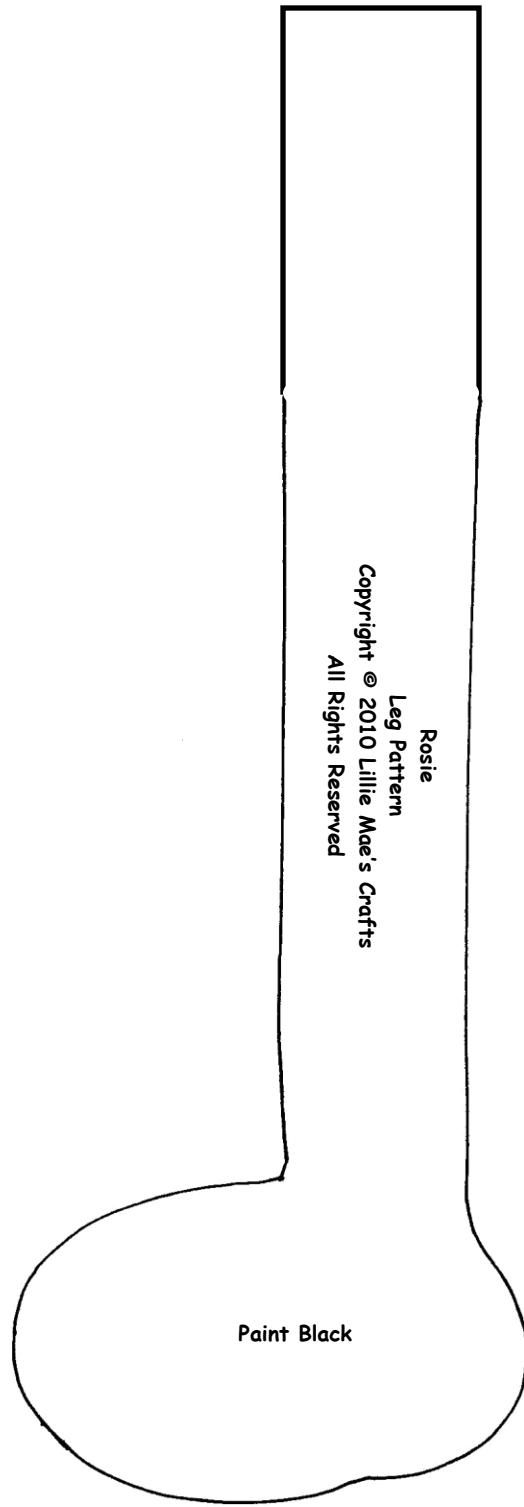
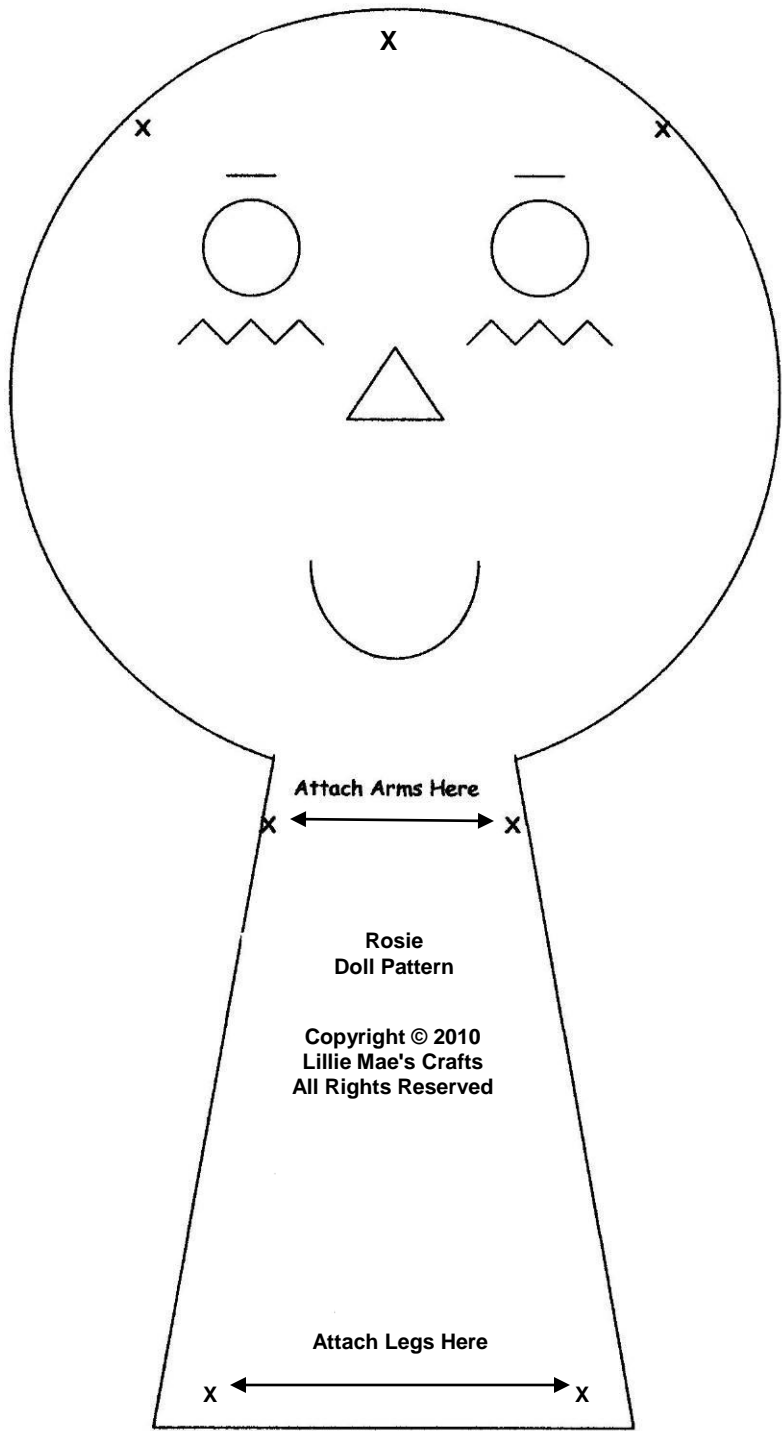

Rosie  
Leg Pattern  
Copyright © 2010 Lillie Mae's Crafts  
All Rights Reserved

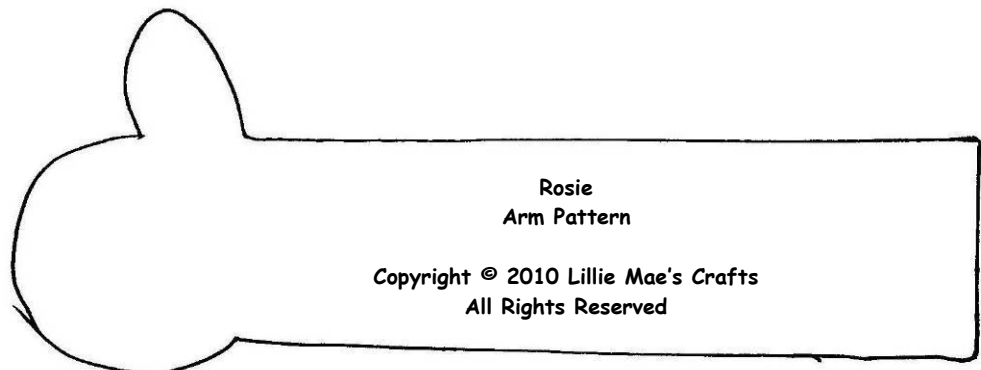

Neck Opening

Rosie

Bodice Pattern

Copyright © 2010 Lillie Mae's Crafts  
All Rights Reserved

Attach Skirt Here

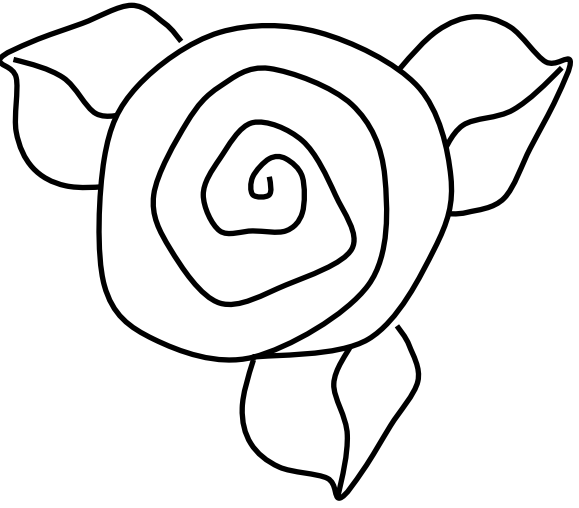

#### Facial Features

**Eyes & Nose:** Print and cut out pattern. Position on face where desired and attach to doll head with straight pins. Be sure eyes are even and lightly trace around all patterns with mechanical pencil or disappearing fabric pen.

**Mouth:** Print and cut out pattern on cardstock. Position on face where desired and attach to doll head with straight pins. Lightly trace with pencil or disappearing fabric pen the very bottom curve of the attached mouth and up the sides to the point of the bolded middle line printed on the mouth pattern. For the sides of the mouth (dimples), line up the sides of the printed out mouth pattern where you would like the curves to go and again trace.

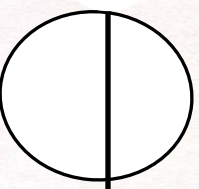
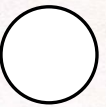
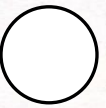

**Rosie  
Skirt Pattern**

**Copyright © 2010 Lillie Mae's Crafts  
All Rights Reserved**

**Place on Fold**

**Rosie  
Hair Card**

**Wrap yarn around card 50 times.**