

Good Night Sweetie

Approximately 15-1/2 inches tall

You Will Be A Needin':

Material: Muslin, white eyelet material for nightgown, white scraps for pillow, scraps of blue/white striped material for pillowcase
Chenille - for house slippers

Stuffing

Needles: Doll needle (3 or 5 inches long) and beading needle

Mechanical pencil

Wood or plastic ruler

Paint: Black, white, Barnyard red

Yarn: Thick, fuzzy, red yarn for hair

Embroidery thread: Dark brown, red to match hair and for nose, white

Card stock

Black seed beads (Teddy's eyes)

Small paintbrushes

Small stencil brush

Staining: Instant coffee, vanilla extract, fragrance oil. Optional for staining: Old cookie sheet, rags, wax paper, glass jar with lid.

Lillie Mae's Crafts

Charming & Winsome Raggedy Annie & FolkArt Patterns

USA * Muncie, IN

<http://www.lilliemaesCrafts.com>

lilliemaesCrafts@yahoo.com



Good Night Sweetie
By Brenda Greenwalt of Lillie Mae's Crafts



Lillie Mae's Crafts

A Lillie Mae's Crafts original design by Brenda Greenwalt

Good Night Sweetie

Approximately 15-1/2 inches tall

Read through all directions before beginning.

For illustrations of the different steps and techniques as well as the stitches visit my "Stitch 'n' Stuff" page on my website at <http://www.lilliemaescrafts.com>

Sweetie:

#1. Body: On doubled muslin, with a mechanical pencil or disappearing ink fabric pen, lightly trace completely around body patterns. Sew directly on the traced lines; leave open where indicated. Cut out about 1/4 inch away from sewn lines. Clip curves and turn. Stuff head and body firmly and sew opening closed.

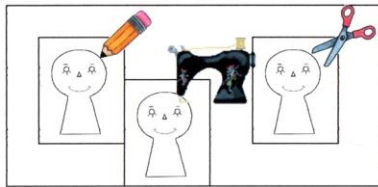

#2. Stuff arms and legs to stuffing line (indicated on pattern) firmly. Sew openings closed. Attach arms where indicated on pattern.

***The legs are not attached yet as they need to be painted, however, they do get stained so the next is staining the head, body, arms, and legs.

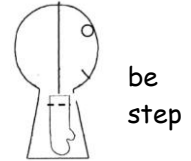

Staining: Combine $\frac{1}{4}$ cup instant coffee, 2 cups hot water, 2 Tablespoons Vanilla extract and $\frac{1}{4}$ teaspoon fragrance oil (Some of my preferred scents are cinnamon bun, sugar cookies, and vanilla) in a glass jar with lid. Shake for few minutes until thoroughly mixed. (See the supply list on back of pattern cover for some suggested places for purchasing fragrance oils.) If the scent is not strong enough for your preference, add another 1/8 teaspoon of fragrance oil and continue this until the scent is to your liking. However, I would suggest only adding 1/8 teaspoon of fragrance oil each time because if you add too much and the scent is too strong for you, you will have to start over. Line an old cookie sheet with old rags and lay your doll here. With a sponge brush, thoroughly coat the doll. Bake for 10 minutes at 200 degrees. Check often as this can catch on fire. If you have to bake longer, only bake at 5 minute increments and always KEEP checking the oven. Tip: DO NOT turn your doll over while in the oven...unless you want big black splotches (of course some prim crafters might want these). I know this from experience. See staining section below.

Finish Legs:

#1. After staining legs and they are dry, attach a loop of thread to top of the legs (this is for hanging to dry).

#2. Whitewashing - In a glass jar with lid, mix 1 Tablespoon white acrylic paint with 1/3 cup water. Shake to mix thoroughly. Paint legs and hang to dry. **NOTE:** I use an old wire hanger; just bend both sides up and hang one leg on each side. Be sure to hang where



any

paint drips (if any) will not harm carpet, etc.; I hang mine in my garage. Once dry, sand lightly.

#3. After whitewashing legs and they are dry, it's time to paint the stripes. Dip a little of your Barnyard Red acrylic paint onto a paper plate. With a small stencil brush, dip it lightly in the paint and stomp most of the paint off onto paper towels. I prefer a more vintage look to my Annie's so I stomp my brush onto the paper towels until it appears as if there is no paint left (believe me, there still is); however, if you prefer a more colorful Annie only stomp your brush a few times onto the paper towels. Follow pattern and lightly paint on leg stripes. Hang again to dry.

#4. Sew to body where indicated on pattern.

Face:

#1. **Eyes:** Print and cut out the eyes (in pattern section). Position these on the face where you want them and pin them to the face with straight pins. Very lightly trace around these with a mechanical pencil; use a mechanical pencil as it leaves a thinner line than a regular pencil. If using a regular pencil, your lines will be thicker therefore when you paint the eyes in they will be larger than the pattern. With a very small brush and using your black acrylic paint, very slowly outline eyes first and then fill in. Once that has dried, using the end of a very narrow small paint brush, dip it lightly in the antique white paint and gently dot on the whites of her eyes (see picture for placement).

#2. **Nose:** Print and cut out nose pattern. Position on face and pin using straight pins. Very lightly trace around this with a mechanical pencil. Using a double strand of red embroidery thread go in from the top of the head (this will be covered with her hair), use the satin stitch for the nose. If unsure of the satin stitch, visit my "Stitch 'n' Stuff" page for an illustration. Tip - I usually unthread my doll needle here and rethread on a smaller, sharper needle which helps me stay in the lines of the nose.

#3. **Mouth:** Print and cut out the mouth pattern being careful to get the right mouth on the right doll. Position it on your doll's face making sure the "centering line" is lined up with the centering line on the nose and pin with straight pins. Very lightly trace around the bottom curve of the mouth pattern (with a mechanical pencil) going up the sides of the mouth just to the bolded line and stopping there. Thread your 3-inch doll needle with 1 strand of your brown embroidery thread. Going in at the very top of her head (as in step #2) embroider the mouth using a simple backstitch.

#4. **Eyelashes & Eyebrows:** With a mechanical pencil and using the picture as a pattern, trace in eyelashes. Tip - use a ruler, each eyelash is slightly longer than 1/4 inch long. Thread your doll needle with a single strand of brown embroidery thread and use the same technique as in step #2 backstitch the eyelashes. Do the same for the eyebrows which should measure 1/4 inch across.

#5. **Cheeks:** Dip some Barnyard Red paint onto a paper plate. Dip your stencil brush lightly into the paint and pounce off most of it onto the paper towels. Unless you want her cheeks very bright, be sure to pounce off MOST of the paint. If her cheeks are not colorful enough for you, you can always add more...but begin by applying only a small amount. With your stencil brush and checking picture on pattern for placement of cheeks, in a circling motion, paint on cheeks.

Hair:

#1. Print off hair card on card stock.

#2. Cut 11 pieces of embroidery thread that matches your yarn chosen for the doll's hair; insert one in each of the places marked on her head pattern.

#3. Making a hair bundle: Wrap yarn (hair) around hair card 10 times; slide off. Clip bottom loops. Lay hair bundle in center of one of the pieces of embroidery thread and tie tightly. Do this for all of her hair. Trim.

#4. Tie a few strands of white embroidery floss around a few strands of hair.

Nightgown:

#1. Print and cut out the nightgown pattern. On double layer white material, trace pattern being sure to place on fold where indicated. Cut out 2.

#2. Place right sides together and using 1/4 inch seam allowance, sew as indicated on pattern.

#3. Turn hem under 1/4 inch and hem.

#4. Turn sleeves under 1/4 inch and hand stitch with a running stitch.

#5. Hand sew a running stitch around neck and pull to gather; secure in back.

Fuzzy House Slippers:

#1. Print and cut out "House Slipper" pattern.

#2. Trace on wrong side of doubled chenille, pin and cut out.

#3. Fold over and, looking at the illustration, sew on dashed lines. Turn.

#4. Fray check all around the upper part of the house slipper to keep it from unraveling.

#5. Turn the top, which is an unfinished edge, of the house slipper in and, with a hand stitch, sew a running stitch all around the upper part of the shoe.

Teddy Bear:

#1. Print out both teddy bear patterns.

#2. On doubled material, trace the "teddy bear front" pattern; cut out.

#3. On doubled material, trace the "teddy bear back" pattern being sure to place on fold where indicated on pattern; cut out.

#4. Take the two fronts and, with right sides together, pin from one "x" to the other; sew using 1/4 inch seam allowance.

#5. With right sides together, pin the back to the front; sew using 1/4 inch seam allowance.

#6. Stuff firmly; sew opening closed.

#7. Stain using the recipe and instructions given above.

#8. When completely dry, sew on the two black seed beads for eyes and embroider the nose. With a simple backstitch, embroider the line from the nose to the mouth and embroider the mouth.

#9. Wrap a few strands of white embroidery floss around the neck and tie in a bow.

Pillow:

#1. Print and cut out pillow and pillowcase patterns.

#2. Trace pillow pattern on doubled white material; cut out.

#3. Using 1/4 inch seam allowance, sew seams being sure to leave open where indicated on pattern.

#4. Stuff firmly; sew opening closed.

#5. Trace pillowcase on doubled material; do NOT cut out. Sew on traced lines being sure to leave open where indicated on pattern. Cut out about 1/4 inch away from sewn lines.

#6. Turn the open ends in about 1/2 inch and hand sew a running stitch all around.

You're done with *Good Night Sweetie*. I hope you enjoyed making her as much as I enjoyed designing them. If you have any problems or questions at all, please don't hesitate to email me or visit my "Stitch 'n' Stuff" page at <http://www.lilliemaescrafts.com>

Terms of Use:

All of my craft patterns are copyrighted. You may create a reasonable amount of items from my patterns for craft fairs, bazaars, craft malls, and auctions as long as you give Lillie Mae's Crafts credit for the design. You MAY NOT mass produce items from my patterns. Copying for any reason at all is strictly prohibited. You DO NOT have permission to alter them in any way. No wholesaling of items made from my patterns. My patterns are not to be shared or redistributed in any form without my express permission. If you have any questions, please ask before you purchase. Feel free to e-mail me at lilliemaescrafts@lilliemaescrafts.com

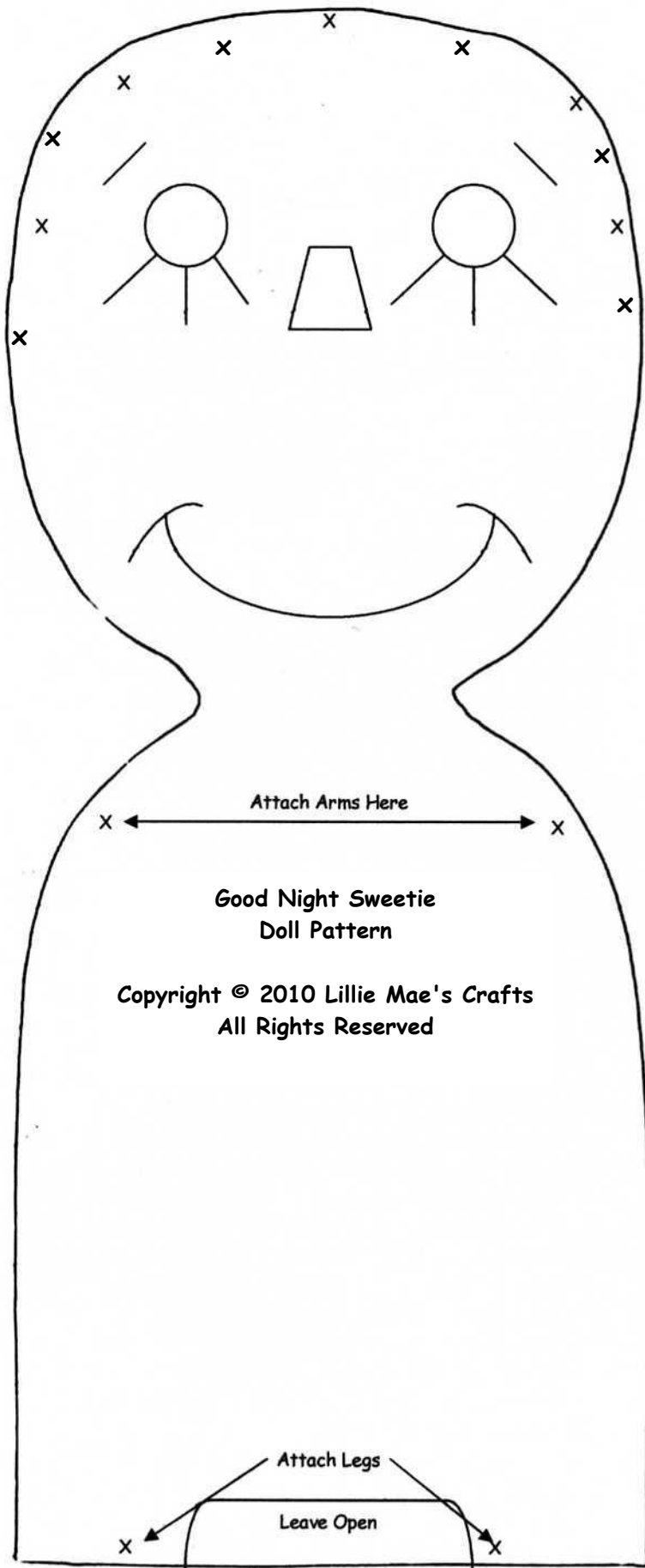

**Good Night Sweetie
Doll Pattern**

Copyright © 2010 Lillie Mae's Crafts
All Rights Reserved



Leave Open

Stuffing Line

**Good Night Sweetie
Arm Pattern**

Neck

Good Night Sweetie
Nightgown Pattern

Copyright © 2010 Lillie Mae's Crafts
All Rights Reserved

Place on Fold

Leave Open

Stuffing Line

Paint red stripe

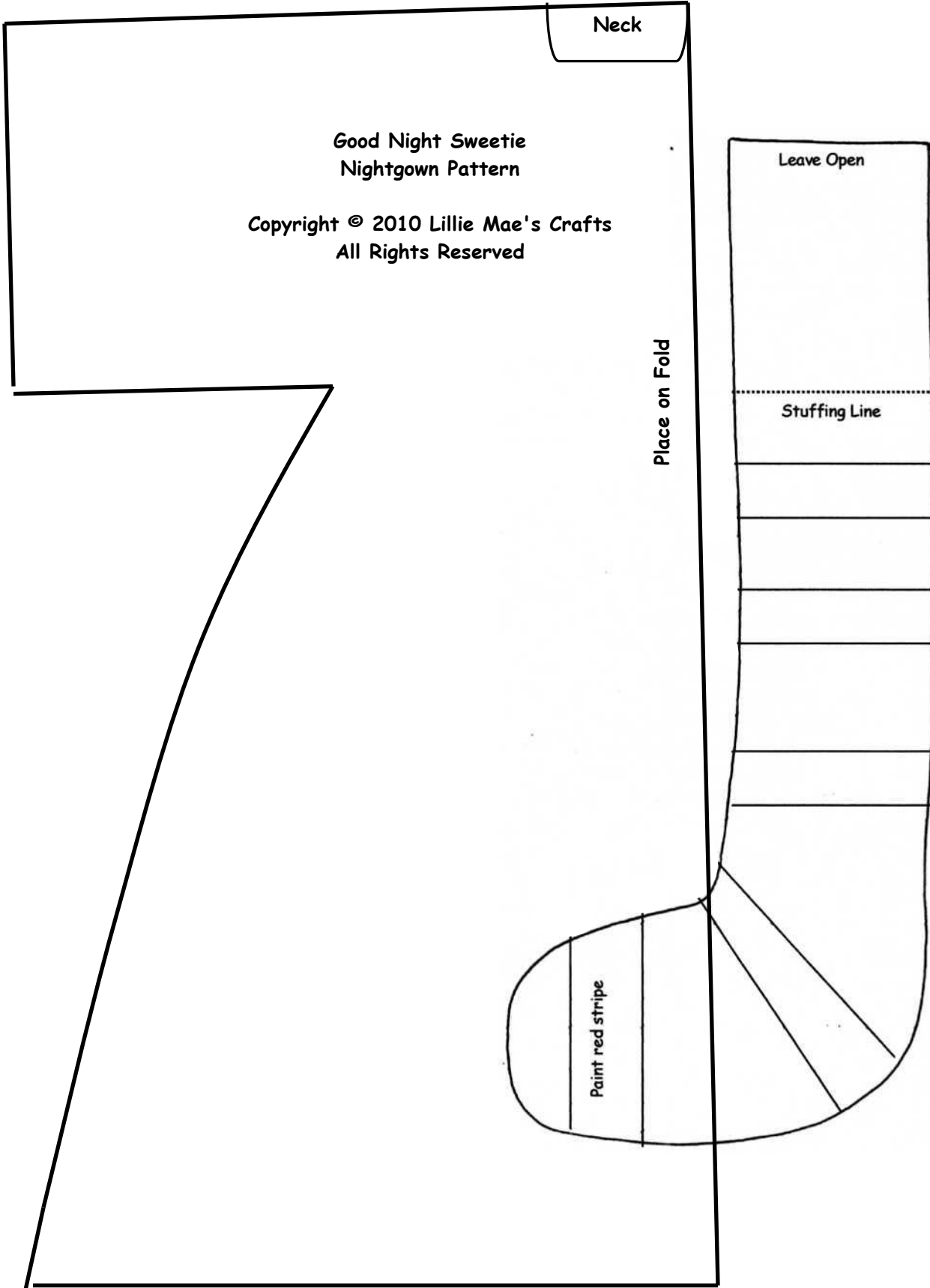

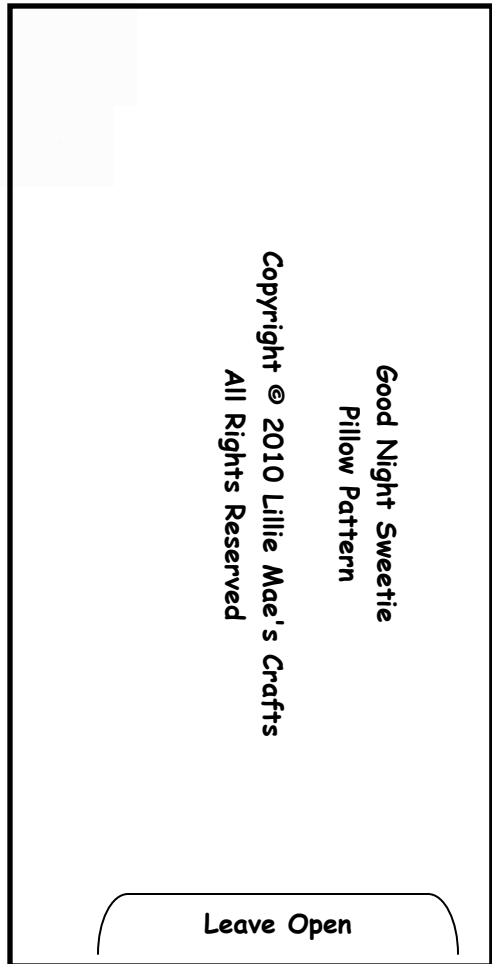
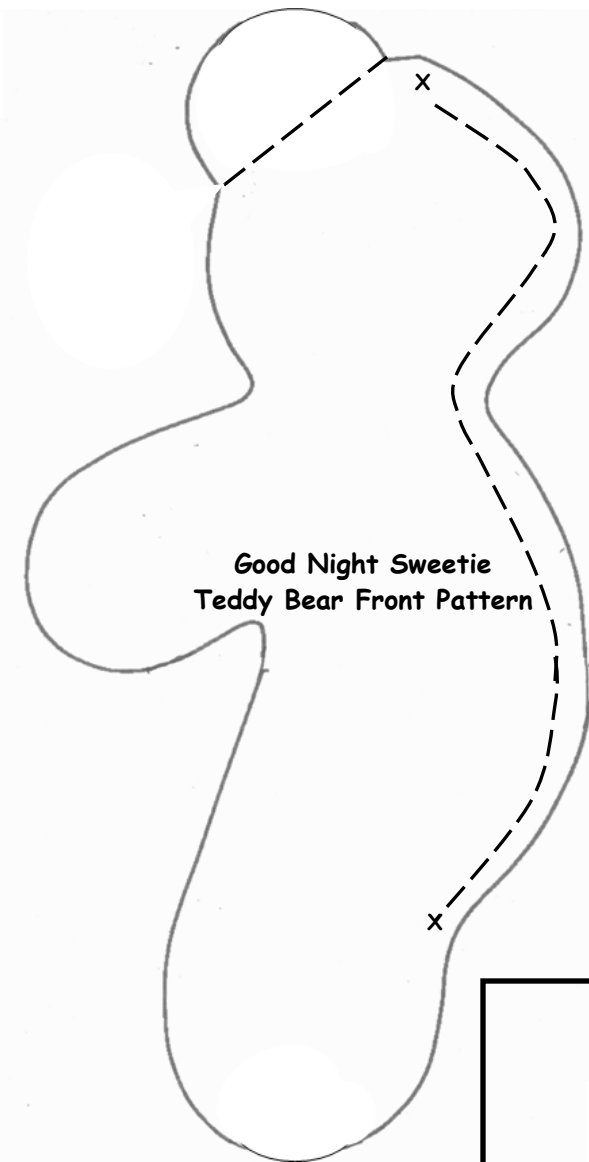
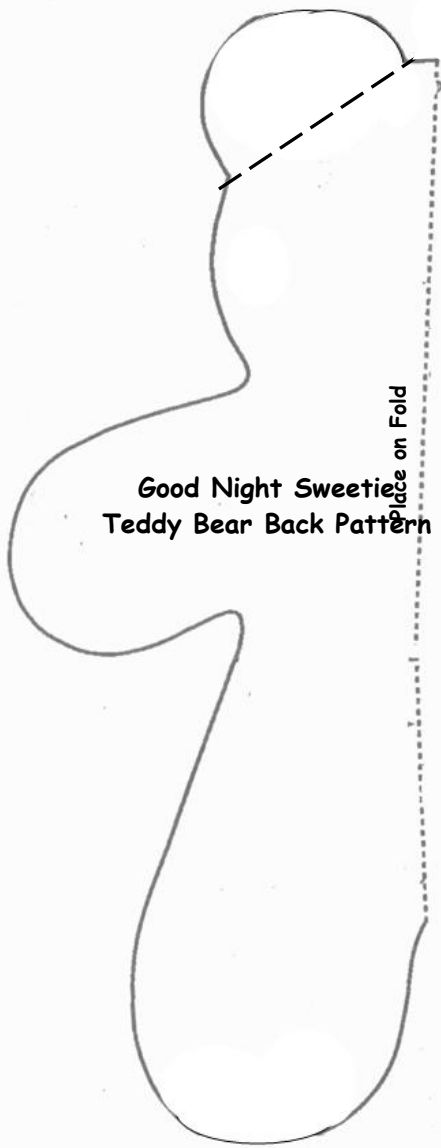

**Good Night Sweetie
House Slipper Template**

**Copyright © 2010 Lillie Mae's Crafts
All Rights Reserved**

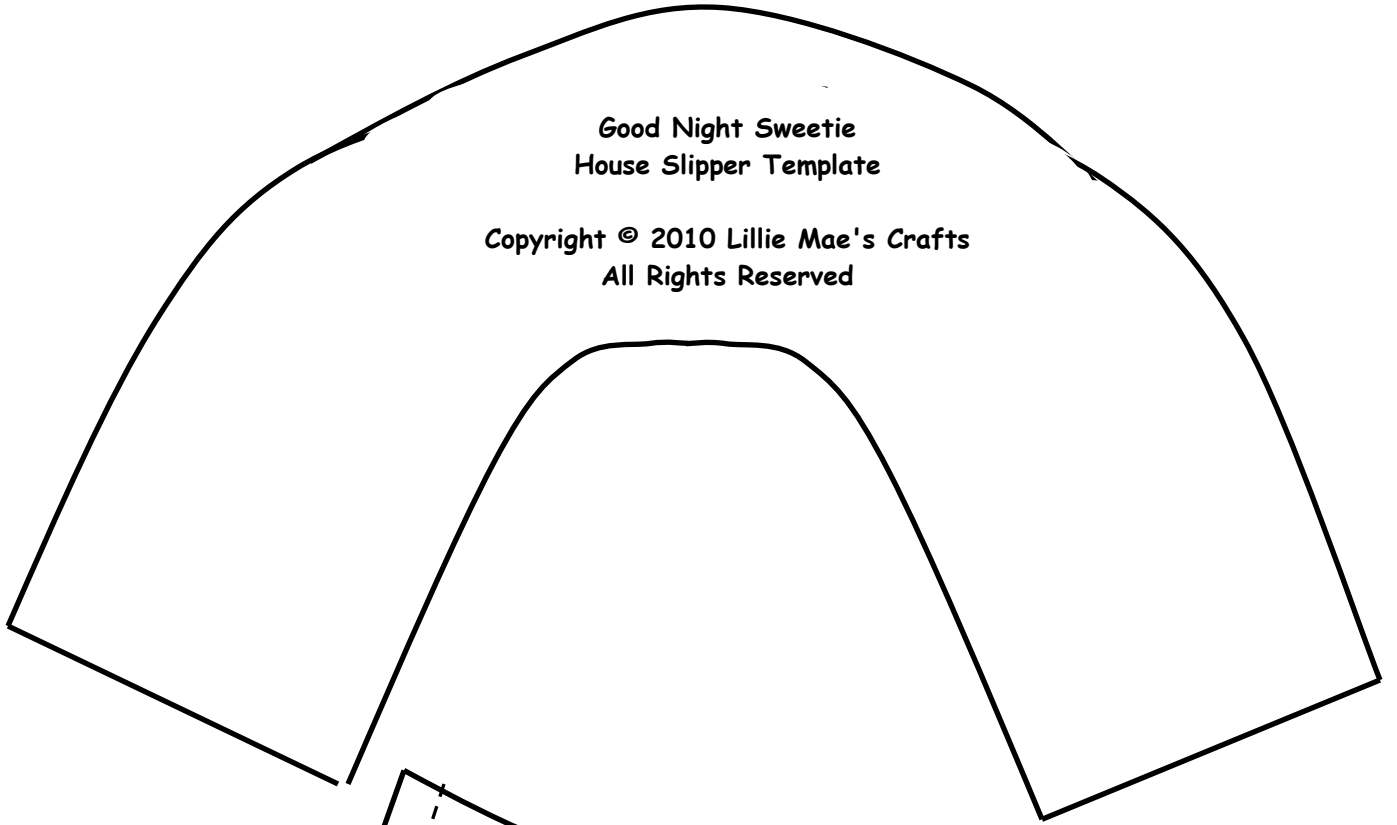

House Slipper Illustration #1

Print & cut out shoe template. Trace on single layer chenille; cut out. Fold over (as in this illustration) and sew on dotted lines. Glue insole & outer sole as in pattern instructions.

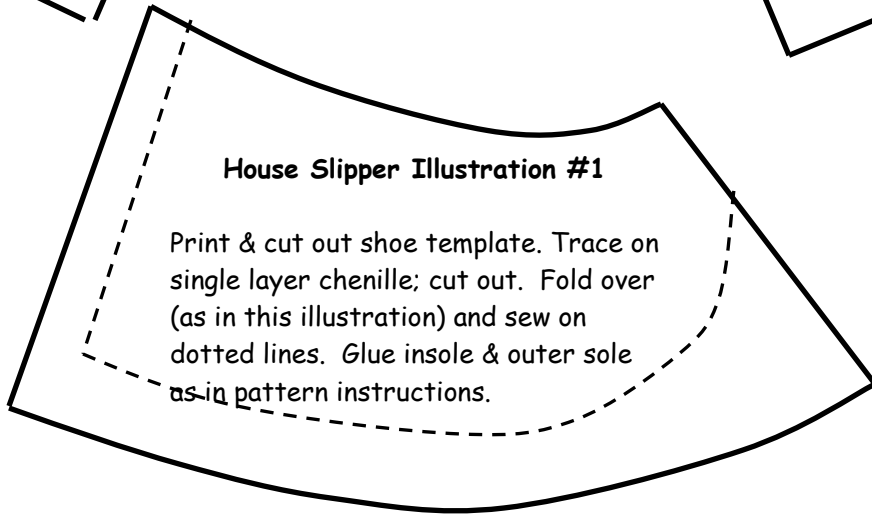

**Good Night Sweetie
Pillowcase Pattern**

**Copyright © 2010 Lillie Mae's Crafts
All Rights Reserved**

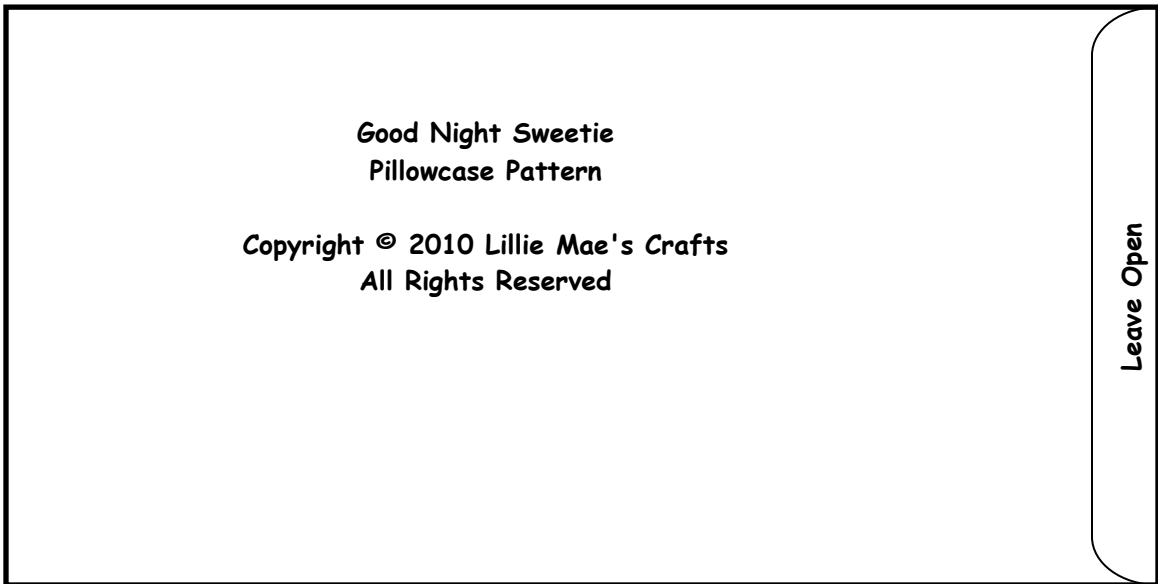

Leave Open