

Supply List

Material: Unbleached muslin, material for dress, apron, and bloomers.

Country red 4-ply yarn (hair)

Embroidery Thread: Brown #433, red #347, thread that matches dress, apron and bloomers, and hair.

Ribbon (for braids) 1/8 inch wide

Stuffing

Mechanical Pencil

For Staining - instant coffee, vanilla extract, fragrance oil, wire hanger.

Paint - Barnyard Red

Sponge brush & large stencil Brush

Paper towels and paper plates

Card stock (for hair cards)

Small safety pin

Black flat shiny buttons (2 holes) 5/8 inch.

5-inch doll needle

Small embroidery needle

Optional - old cookie sheet, glass jar with lid, wax paper, pliers, long beading needle (see #1 of face instructions)

Suggested shopping for fragrance oils -

The Chemistry Store - <http://www.chemistrystore.com>

From Nature With Love - <http://www.fromnaturewithlove.com>

Save on Scents - <http://www.saveonscents.com>

Bramble Berry - <http://www.brambleberry.com>

To Die for Soap - <http://www.todieforssoap.com>

Lillie Mae's Crafts

Charming & Winsome Raggedy Annie Patterns

Brenda Greenwalt * Muncie, IN USA

<http://www.lilliemaeecrafts.com>

E-Mail - lilliemaeecrafts@yahoo.com

Clara Anne



Lillie Mae's Crafts

Lillie Mae's Crafts

A Lillie Mae's Crafts original design by Brenda Greenwalt

Clara Anne

Approximately 19 inches tall.

Read through all directions before beginning.

For illustrations of the different steps and techniques as well as the stitches visit my "Stitch 'n' Stuff" page on my website at <http://www.lilliemaescrafts.com>

Instructions:

- #1. Print out pattern pieces on card stock. Tape arms and legs to body pattern - fit arm patterns where appropriate (see pattern) and tape; do the same with the leg patterns.
- #2. Pin pattern to doubled muslin and trace using pencil, disappearing or Mark B Gone fabric marking pens.
- #3. Sew on traced lines; do not leave an opening. I stuff my dolls fairly firmly; to prevent seams from popping due to stress placed on them, set your sewing machine for small stitches.

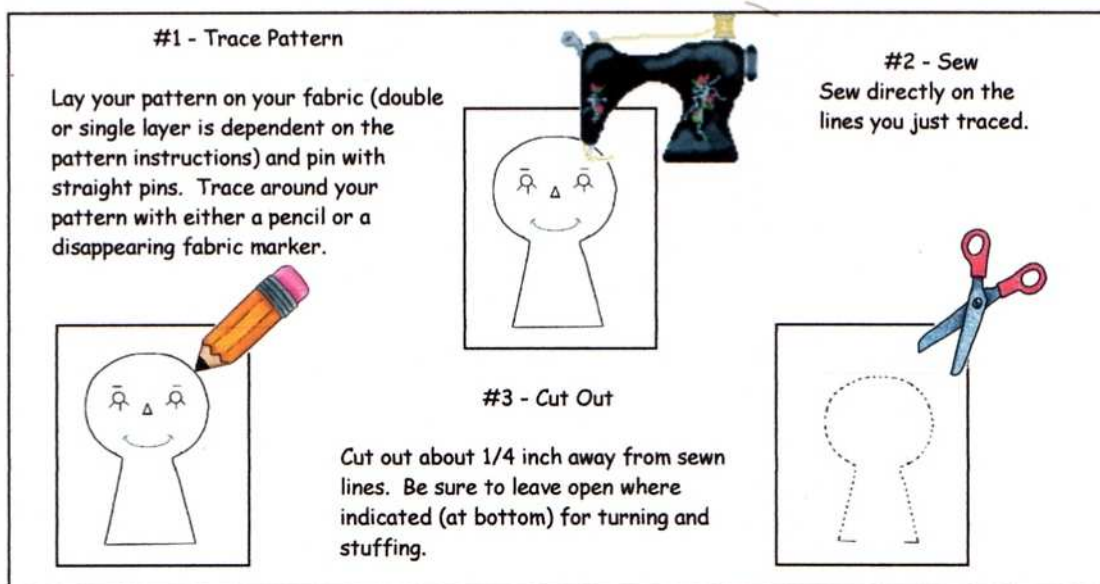

#4. After sewing your doll, cut her out with pinking shears; this helps soften the edges, helps ease the pieces into tight areas such as the neck, and removes all the bulk that can hamper a good, smooth curve. Gives a smoother finish to your doll.

#5. On back, cut a small opening for turning in the shape of an X, turn pattern.

#6. Stuff arms first to stuffing line (see pattern), about 2 inches from shoulder part of arm (can mark this on doll with disappearing fabric marking pen). Sew dividing line for arms (gives them the "rag doll" effect). Spray water when stuffing...shrinks the muslin and results in a tighter smoother look to your doll. Tip - spray each section of the doll right before stuffing that area.

#7. Stuff legs next to stuffing line (see pattern), about 2 inches beginning of leg (can mark this on doll with disappearing fabric marking pen). Sew dividing line for legs (gives them the "rag doll" effect).

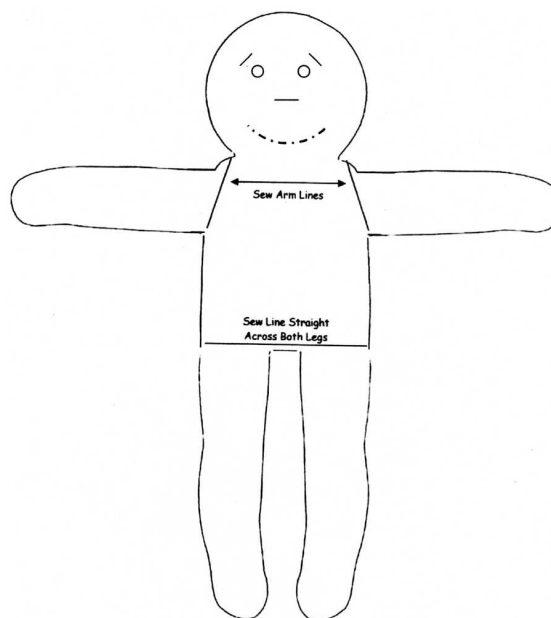

- #8. Continue stuffing the rest of the doll firmly.
- #9. Sew opening on the back closed.

Stain:

- #1. Mix stain solution; in a glass jar with lid combine 1/4 cup instant coffee with 1 cup hot water. Add 2 teaspoons vanilla extract and 1/4 teaspoon fragrance oil. Shake to mix. If you want your stain mixture more fragrant, simply add more fragrance oil. Pour into a spray bottle or use sponge brush.
- #2. Line an old cookie sheet with either wax paper or old rags.
- #3. Spray body being sure she is completely covered; front and back.
- #4. Set oven to 200 and bake for 10 minutes. NEVER LEAVE THIS UNATTENDED. If you need to bake longer, bake at 5 minute increments.

Face:

- #1. Eyes: Print and cut out the eyes. Position these on the face where you want them and pin them to the face with straight pins. Very lightly trace around these with a disappearing fabric pen. If they look even, then sew the buttons on in these spots. Thread your 5-inch doll needle with your black quilting thread and, going in from the top of her head (this will be covered with her hair) go down and sew the buttons on for her eyes being sure to pull tightly.
- #2. Mouth: Print out mouth pattern, position on face where desired and pin there with straight pins. With a mechanical pencil, trace the bottom edge of the mouth pattern and up the sides to the point of the bolded line (in the middle of the mouth pattern). Thread your 3-inch doll needle with 1 strand of your red embroidery thread. Going in at the very top of her head (this will be covered up with her hair) embroider the heart in the center of the mouth first; then, using the same technique embroider the mouth with 1 strand of your brown embroidery thread.
- #3. Nose: Follow instructions given in "Facial Features" in pattern section. Print and cut out nose pattern. Position on face and pin using straight pins. Very lightly trace around this with a mechanical pencil. Using a double strand of red embroidery thread and using same technique as in step #2, backstitch the nose. Tip - I usually unthread my doll needle here and rethread on a smaller, sharper needle. This helps me stay in the lines of the nose.
- #4. Eyebrows & Eyelashes: With a mechanical pencil and using the picture as a pattern, trace in eyebrows and eyelashes...using a ruler, the eyelashes and eyebrows are 1/4 inch. Thread your doll needle with a single strand of brown embroidery thread and use the same technique as in step #2 backstitch the eyelashes first and then the eyebrows.
- #5. Cheeks: Dip some red paint onto paper plate. Dip your stencil brush lightly into the paint and pounce off most of it onto the paper towels. Unless you want her cheeks very bright, be sure to pounce off MOST of the paint. If her cheeks are not colorful enough for you, you can always add more...but begin by applying only a small amount. In fact I will pounce my brush onto the paper towel until the brush appears as though there is no paint left (believe there is still plenty). With your stencil brush and checking picture on pattern for placement of cheeks, in a circling motion, paint on cheeks. Allow to dry.

Hair:

- #1. Make your hair bundle - cut 30 pieces of your country red yarn 25 inches long. With a matching piece of yarn, tie in the very center.
- #3. Insert pieces of matching embroidery thread in the three places on head as indicated on pattern. Leave these pieces of thread lying open.
- #4. Center the bundle of hair at the very top of doll's head and tie down with the matching piece of embroidery thread you have inserted there. Then tie hair bundle on both sides of this.
- #5. Braid each side and tie at bottom of braid with matching piece of embroidery thread. Trim.
- #6. Tie ribbon around ends of braids.

Dress:

- #1. Print and cut out the dress pattern. On double layer material, trace dress pattern being sure to place on fold where indicated. Cut out 2.
- #2. Place right sides together and using 1/4 inch seam allowance, sew as indicated on pattern.
- #3. Turn sleeves under 1/4 inch and hand stitch.
- #4. Turn neck under 1/4 inch and hand sew a gathering stitch completely around neck. Once on doll, pull to gather and tack down in the back.
- #5. Turn hem under 1/4 inch and hem.

Apron:

- #1. A regular 8-1/2" x 11" sheet of paper will be your pattern. See Illustration.
- #2. Wrap piece of ribbon around and tie in front.

Pantaloons/Bloomers:

- #1. Print and cut out pantaloon pattern.
- #2. On doubled unbleached muslin, trace pattern with mechanical pencil.
- #3. Sew on traced lines, outside as well as inside seams. Cut out about 1/4 inch from sewn lines. Clip curves and turn.
- #4. Turn waistline down 1/2 inch and with matching piece of embroidery thread hand sew a running stitch completely around, pull to gather and tie in a bow in front.
- #5. With bloomers still wrong side out and with disappearing fabric marking pen, mark a line completely around the end of each leg 1/2 inch up from very bottom. With matching embroidery thread, hand sew a running stitch. After putting bloomers on doll, pull to gather and tie ribbon around each leg, tie in bow in front.

Terms of Use:

All of my craft patterns are copyrighted. You may create a reasonable amount of items from my patterns for craft fairs, bazaars, craft malls, and auctions as long as you give Lillie Mae's Crafts credit for the design. You MAY NOT mass produce items from my patterns. Copying for any reason at all is strictly prohibited. You DO NOT have permission to alter them in any way. No wholesaling of items made from my patterns. My patterns are not to be shared or redistributed in any form without my express permission. If you have any questions, please feel free to e-mail me at lilliemascrafts@yahoo.com

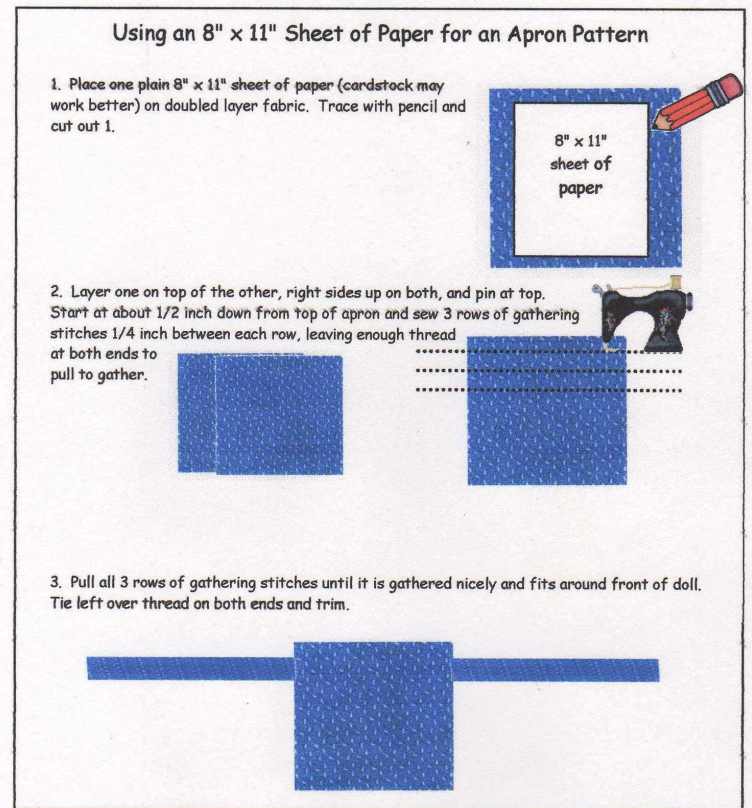

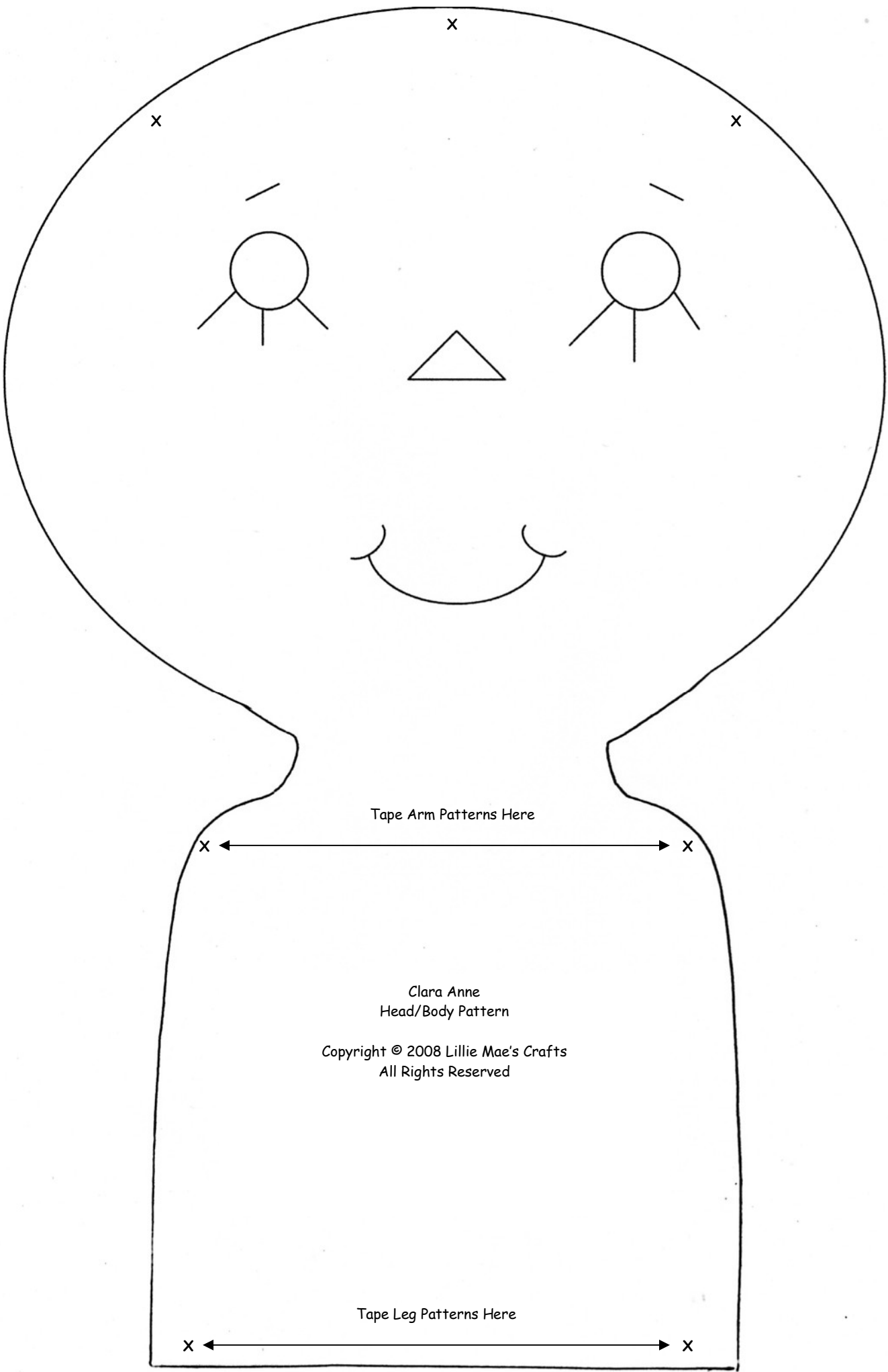

Tape Arm Patterns Here

Clara Anne
Head/Body Pattern

Copyright © 2008 Lillie Mae's Crafts
All Rights Reserved

Tape Leg Patterns Here

Facial Features

Eyes & Nose: Print and cut out pattern. Position on face where desired and attach to doll head with straight pins. Be sure eyes are even and lightly trace around all patterns with mechanical pencil or disappearing fabric pen.

Mouth: Print and cut out pattern on cardstock. Position on face where desired and attach to doll head with straight pins. Lightly trace with pencil or disappearing fabric pen the very bottom curve of the attached mouth and up the sides to the point of the bolded middle line printed on the mouth pattern. For the sides of the mouth (dimples), line up the sides of the printed out mouth pattern where you would like the curves to go and again trace.

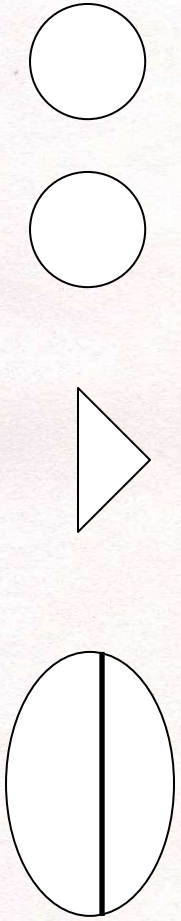

Clara Anne
Arm Pattern

Copyright © 2008 Lillie Mae's Crafts
All Rights Reserved

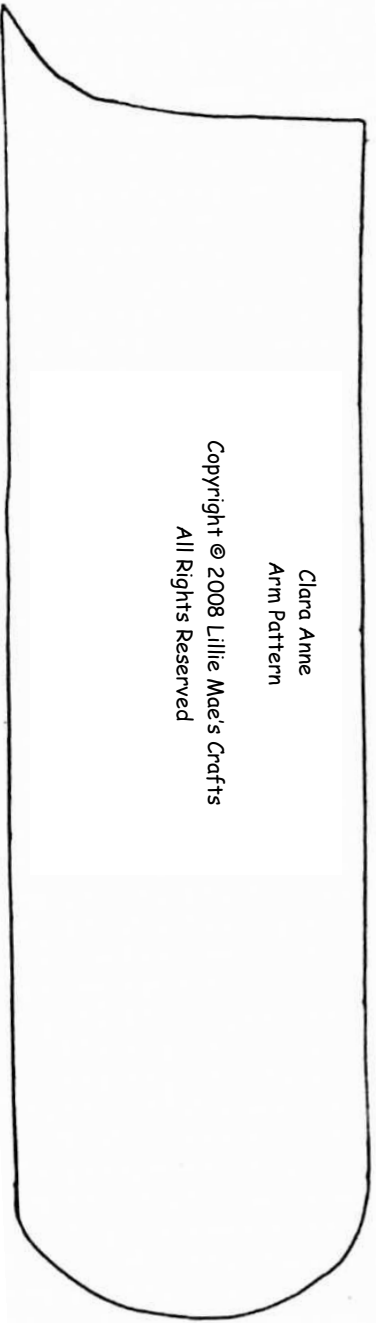

Clara Anne
Leg Pattern

Copyright © 2008 Lillie Mae's Crafts
All Rights Reserved

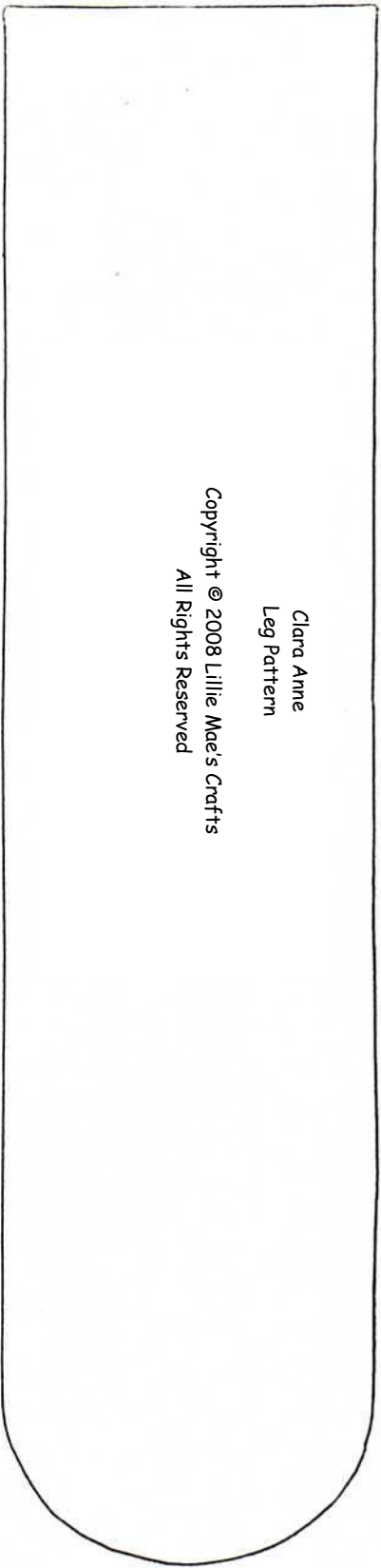

Neck Opening

Clara Anne
Dress Pattern

Copyright © Lillie Mae's Crafts
All Rights Reserved

Place on Fold

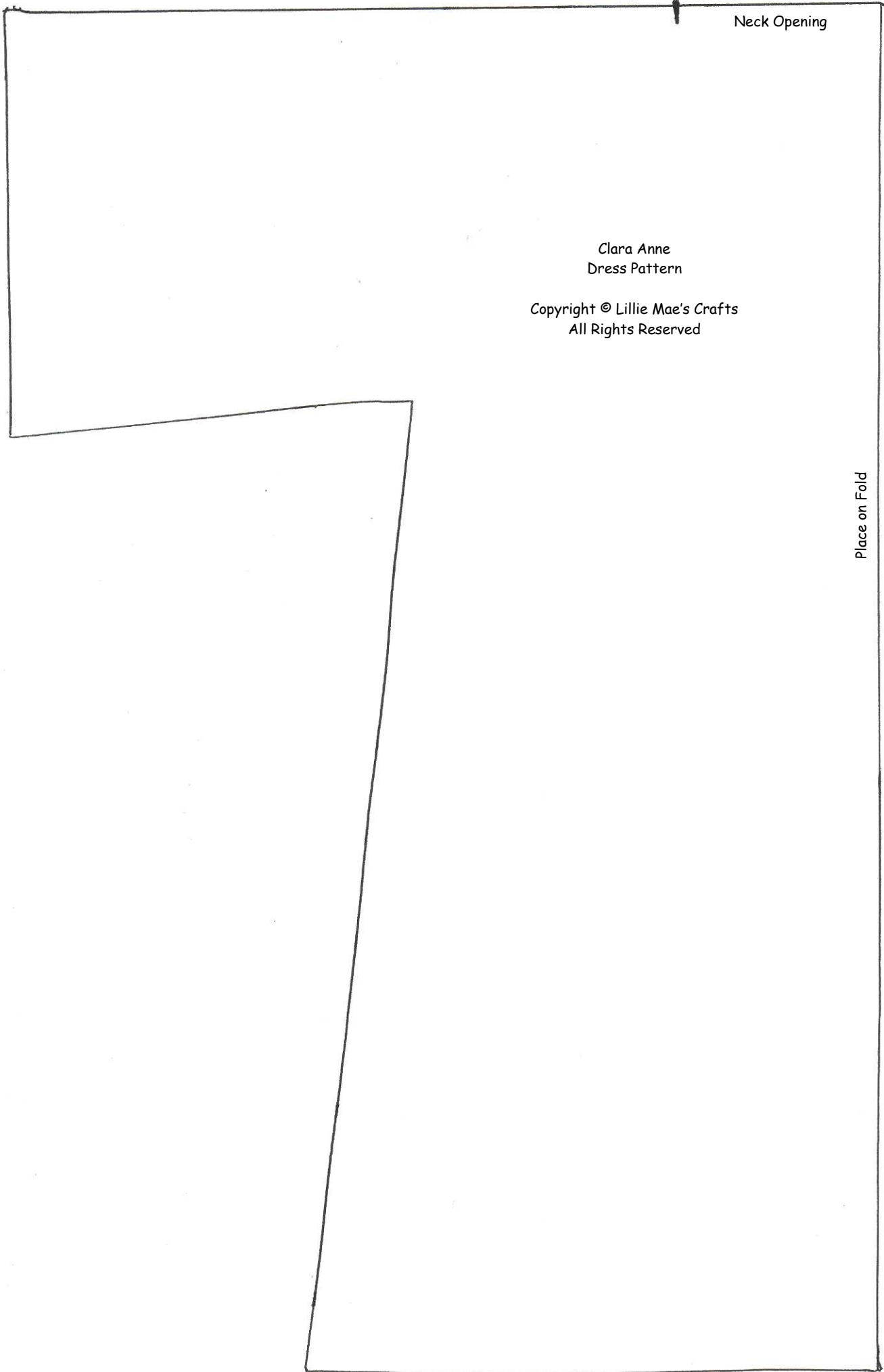

Clara Anne
Bloomers Pattern

Copyright © Lillie Mae's Crafts
All Rights Reserved

Place on Fold

